

Installation Instructions Axis Midi

For Trimmed installations

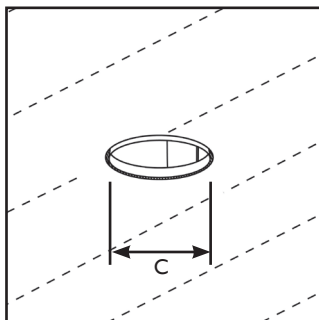

MAINS POWER TO BE SWITCHED OFF DURING INSTALLATION.



1) Cut-out hole 141mm dia

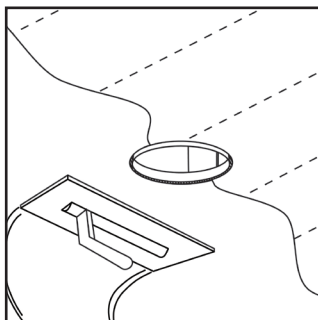

2) Plaster the ceiling

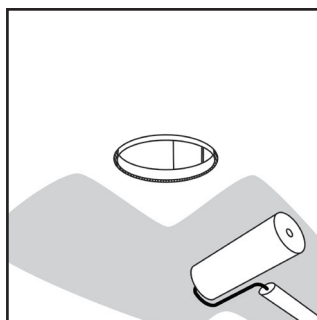

3) Finish the ceiling.

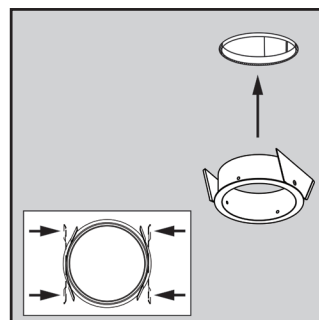

4) Install installation kit

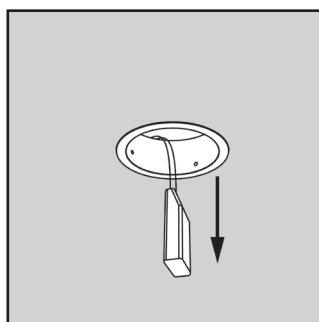

5) Connect control gear/driver

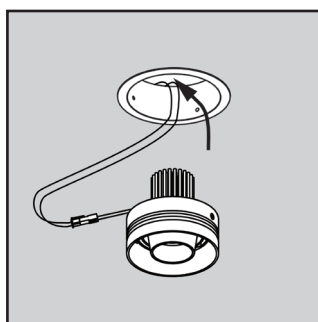

6) Connect to to luminaire

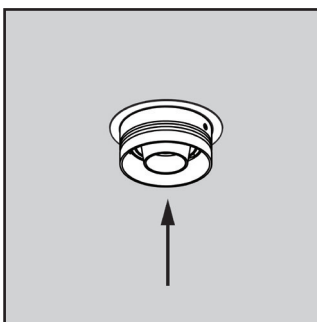

7) Install fixture.

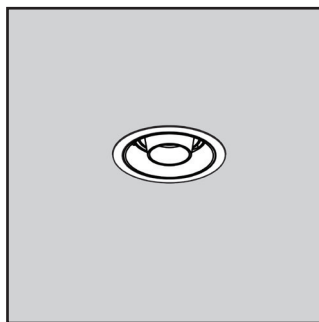

8) Installation complete

Fixture Adjustment Instructions

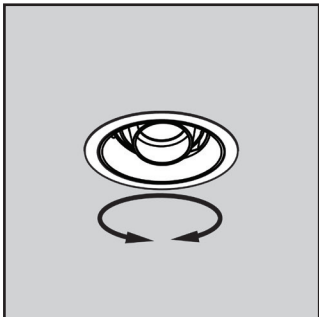

1. Adjust rotation

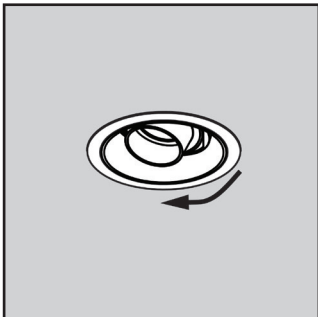

2. Adjust tilt